



# Internal Star Impact Drivers



## ★ No. 1234T 1/4", 3/8", 1/2" Drive Internal Star Set



### 12 piece set contents:

- 6 Pieces 1/4" Drive Star Sizes:  
T10, T15, T20, T25, T27, T30
- 5 Pieces 3/8" Drive Star Sizes:  
T40, T45, T47, T50, T55
- 1 Piece 1/2" Drive Star Size:  
T60
- Molded Storage Case

## ★ No. 996T 1/4" Drive Internal Star Set



### 6 piece set contents:

- 6 Pieces 1/4" Drive Internal Star Sizes:  
T10, T15, T20, T25, T27, T30
- on a Metal Clip Rail

Star

## ★ 1/4" Drive Individual Internal Star Drivers

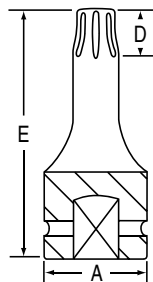

Item Number	Star Size	Dimensions (Inches)		
		A	D	E
<b>910T</b>	<b>T10</b>	.51	.11	1.38
<b>915T</b>	<b>T15</b>	.51	.11	1.38
<b>920T</b>	<b>T20</b>	.51	.11	1.38
<b>925T</b>	<b>T25</b>	.51	.12	1.38
<b>927T</b>	<b>T27</b>	.51	.12	1.38
<b>930T</b>	<b>T30</b>	.51	.15	1.38



# 3/8" Drive Internal Star Impact Drivers



## No. 1200T 3/8" Drive Internal Star Set



9 piece set contents:

9 Pieces 3/8" Drive Internal Star Sizes:  
T20, T25, T27, T30, T40, T45, T47, T50, T55  
Molded Storage Case



## 3/8" Drive Individual Internal Star Drivers



Item Number	Star Size	Dimensions (Inches)		
		A	D	E
<b>1120T</b>	<b>T20</b>	.75	.11	1.97
<b>1125T</b>	<b>T25</b>	.75	.12	1.97
<b>1127T</b>	<b>T27</b>	.75	.12	1.97
<b>1130T</b>	<b>T30</b>	.75	.15	1.97
<b>1140T</b>	<b>T40</b>	.75	.15	1.97
<b>1145T</b>	<b>T45</b>	.75	.17	1.97
<b>1147T</b>	<b>T47</b>	.75	.20	1.97
<b>1150T</b>	<b>T50</b>	.75	.20	1.97
<b>1155T</b>	<b>T55</b>	.75	.22	1.97

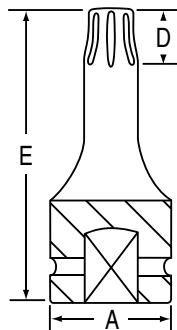

Star



# 3/8" Drive Extended Length Internal Star Impact Drivers



## ★ No. 1206T 3/8" Drive Extended Length Internal Star Set



9 piece set contents:

11206T .....	T20	11456T .....	T45
11256T .....	T25	11476T .....	T47
11276T .....	T27	11506T .....	T50
11306T .....	T30	11556T .....	T55
11406T .....	T40		on a Metal Clip Rail

## ★ 3/8" Drive Individual Extended Length Internal Star Drivers

These extended length Star drivers with 6" overall length are designed for a wide variety of applications where long reach is needed. They are especially useful for automotive trim work as well as many industrial applications.

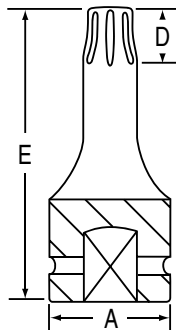

Item Number	Star Size	Dimensions (Inches)		
		A	D	E
<b>11206T</b>	<b>T20</b>	.75	.11	5.91
<b>11256T</b>	<b>T25</b>	.75	.12	5.91
<b>11276T</b>	<b>T27</b>	.75	.12	5.91
<b>11306T</b>	<b>T30</b>	.75	.15	5.91
<b>11406T</b>	<b>T40</b>	.75	.15	5.91
<b>11456T</b>	<b>T45</b>	.75	.17	5.91
<b>11476T</b>	<b>T47</b>	.75	.20	5.91
<b>11506T</b>	<b>T50</b>	.75	.20	5.91
<b>11556T</b>	<b>T55</b>	.75	.22	5.91

Star



# 1/2" Drive Internal Star Impact Drivers



## No. 1300T 1/2" Drive Internal Star Set



8 piece set contents:

8 Pieces 1/2" Drive Internal Star Sizes:  
T30, T40, T45, T47, T50, T55, T60, T70  
Molded Storage Case



## 1/2" Drive Individual Internal Star Drivers



Item Number	Star Size	Dimensions (Inches)		
		A	D	E
<b>2130T</b>	<b>T30</b>	.98	.15	2.95
<b>2140T</b>	<b>T40</b>	.98	.15	2.95
<b>2145T</b>	<b>T45</b>	.98	.17	2.95
<b>2147T</b>	<b>T47</b>	.98	.20	2.95
<b>2150T</b>	<b>T50</b>	.98	.20	2.95
<b>2155T</b>	<b>T55</b>	.98	.22	2.95
<b>2160T</b>	<b>T60</b>	.98	.31	2.95
<b>2170T</b>	<b>T70</b>	.98	.37	2.95

Star

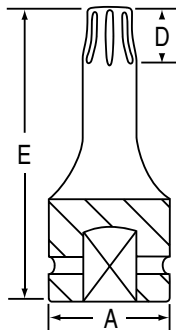



# Tamper-Proof Star Impact Drivers



## ⚙️ No. 1235TT 1/4", 3/8", 1/2" Drive Tamper-Proof Star Set

Tamper-Proof



### 12 piece set contents:

- 6 Pieces 1/4" Drive Star Sizes:  
TT10, TT15, TT20, TT25, TT27, TT30
- 5 Pieces 3/8" Drive Star Sizes:  
TT40, TT45, TT47, TT50, TT55
- 1 Piece 1/2" Drive Star Size:  
TT60
- Molded Storage Case

## ⚙️ 1/4" Drive Individual Tamper-Proof Star Drivers

Tamper-Proof

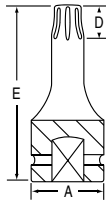

Item Number	Star Size	Dimensions (Inches)		
		A	D	E
<b>908TT</b>	<b>TT8</b>	.51	.08	1.38
<b>909TT</b>	<b>TT9</b>	.51	.08	1.38
<b>910TT</b>	<b>TT10</b>	.51	.11	1.38
<b>915TT</b>	<b>TT15</b>	.51	.11	1.38
<b>920TT</b>	<b>TT20</b>	.51	.11	1.38
<b>925TT</b>	<b>TT25</b>	.51	.12	1.38
<b>927TT</b>	<b>TT27</b>	.51	.12	1.38
<b>930TT</b>	<b>TT30</b>	.51	.15	1.38

## ⚙️ 3/8" Drive Individual Tamper-Proof Star Drivers

Tamper-Proof

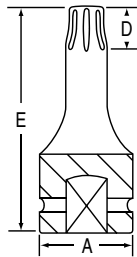

Item Number	Star Size	Dimensions (Inches)		
		A	D	E
<b>1120TT</b>	<b>TT20</b>	.75	.11	1.97
<b>1125TT</b>	<b>TT25</b>	.75	.12	1.97
<b>1127TT</b>	<b>TT27</b>	.75	.12	1.97
<b>1130TT</b>	<b>TT30</b>	.75	.15	1.97
<b>1140TT</b>	<b>TT40</b>	.75	.15	1.97
<b>1145TT</b>	<b>TT45</b>	.75	.17	1.97
<b>1147TT</b>	<b>TT47</b>	.75	.20	1.97
<b>1150TT</b>	<b>TT50</b>	.75	.20	1.97
<b>1155TT</b>	<b>TT55</b>	.75	.22	1.97

## ⚙️ 1/2" Drive Individual Tamper-Proof Star Drivers

Tamper-Proof

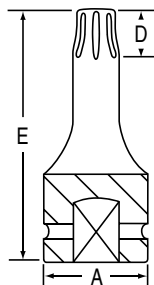

Item Number	Star Size	Dimensions (Inches)		
		A	D	E
<b>2130TT</b>	<b>TT30</b>	.98	.15	2.95
<b>2140TT</b>	<b>TT40</b>	.98	.15	2.95
<b>2145TT</b>	<b>TT45</b>	.98	.17	2.95
<b>2147TT</b>	<b>TT47</b>	.98	.20	2.95
<b>2150TT</b>	<b>TT50</b>	.98	.20	2.95
<b>2155TT</b>	<b>TT55</b>	.98	.22	2.95
<b>2160TT</b>	<b>TT60</b>	.98	.31	2.95
<b>2170TT</b>	<b>TT70</b>	.98	.37	2.95



# 1/4" Drive External Star Impact Sockets



## ET No. 998ET 1/4" Drive External Star Socket Set

8 piece set contents:

8 Pieces 1/4" Drive External Star Sizes:  
E4, E5, E6, E7, E8, E10, E11, E12  
on a Metal Clip Rail



## ET 1/4" Drive Individual External Star Sockets



Item Number	Star Size	Shape	Dimensions (Inches)		
			A	B	E
904ET	E4	I	.51	.22	.98
905ET	E5	I	.51	.28	.98
906ET	E6	I	.51	.31	.98
907ET	E7	I	.51	.35	.98
908ET	E8	I	.51	.39	.98
910ET	E10	I	.51	.47	.98
911ET	E11	II	.51	.49	.98
912ET	E12	II	.57	.55	.98

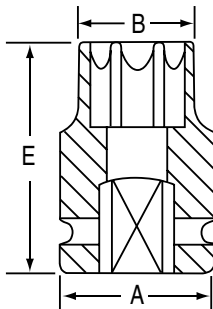

Star





# 3/8" Drive External Star Impact Sockets



## ET No. 1219ET 3/8" Drive External Star Socket Set



9 piece set contents:

9 Pieces 3/8" Drive External Star Sizes:  
E5, E6, E7, E8, E10, E11, E12, E14, E16  
Molded Storage Case



## ET 3/8" Drive Individual External Star Sockets



Item Number	Star Size	Dimensions (Inches)				
		A	B	C	D	E
<b>1105ET</b>	<b>E5</b>	.75	.28	.79	.18	1.26
<b>1106ET</b>	<b>E6</b>	.75	.31	.79	.20	1.26
<b>1107ET</b>	<b>E7</b>	.75	.35	.79	.24	1.26
<b>1108ET</b>	<b>E8</b>	.75	.39	.79	.26	1.26
<b>1110ET</b>	<b>E10</b>	.75	.47	.79	.30	1.26
<b>1111ET</b>	<b>E11</b>	.75	.51	.79	.31	1.26
<b>1112ET</b>	<b>E12</b>	.75	.55	.79	.33	1.26
<b>1114ET</b>	<b>E14</b>	.75	.65	.79	.39	1.26
<b>1116ET</b>	<b>E16</b>	.75	.72	.79	.43	1.26

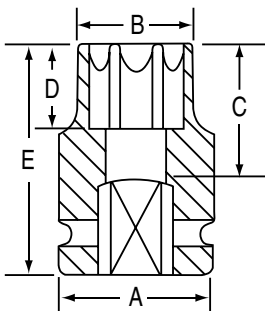

Star



# 1/2" Drive External Star Impact Sockets



## ET No. 1319ET 1/2" Drive External Star Socket Set



9 piece set contents:

9 Pieces 1/2" Drive External Star Sizes:  
E10, E11, E12, E14, E16, E18, E20, E22, E24  
Molded Storage Case



## ET 1/2" Drive Individual External Star Sockets



Item Number	Star Size	Dimensions (Inches)				
		A	B	C	D	E
<b>2110ET</b>	<b>E10</b>	.98	.47	.83	.30	1.50
<b>2111ET</b>	<b>E11</b>	.98	.51	.83	.31	1.50
<b>2112ET</b>	<b>E12</b>	.98	.55	.83	.33	1.50
<b>2114ET</b>	<b>E14</b>	.98	.65	.83	.39	1.50
<b>2116ET</b>	<b>E16</b>	.98	.72	.83	.43	1.50
<b>2118ET</b>	<b>E18</b>	.98	.81	.83	.49	1.50
<b>2120ET</b>	<b>E20</b>	1.18	.89	.83	.55	1.50
<b>2122ET</b>	<b>E22</b>	1.18	.96	1.10	.59	1.77
<b>2124ET</b>	<b>E24</b>	1.18	1.04	1.10	.65	1.77

Star

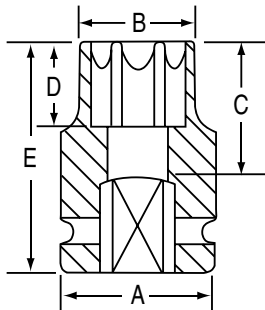



## No. TPX18 Tamper-Proof Star Screwdriver & Key Set

**NOT FOR IMPACT USE**



18 piece set contents:

9 Tamper-Proof Star Screwdrivers and 9 Tamper-Proof Star Keys in sizes: T8, T9, T10, T15, T20, T25, T27, T30, T40 in a molded case.



### Individual Tamper-Proof Star Screwdriver Sizes:

Item Number	Size
<b>TPS08</b>	T8
<b>TPS09</b>	T9
<b>TPS10</b>	T10
<b>TPS15</b>	T15
<b>TPS20</b>	T20
<b>TPS25</b>	T25
<b>TPS27</b>	T27
<b>TPS30</b>	T30
<b>TPS40</b>	T40

### Individual Tamper-Proof Star Key Sizes:

Item Number	Size
<b>TPK08</b>	T8
<b>TPK09</b>	T9
<b>TPK10</b>	T10
<b>TPK15</b>	T15
<b>TPK20</b>	T20
<b>TPK25</b>	T25
<b>TPK27</b>	T27
<b>TPK30</b>	T30
<b>TPK40</b>	T40

Star